

FIRECHIEF REELMAX SWINGING MANUAL FIRE HOSE REELS

FIRECHIEF®
making the world a safer place

MODEL:

RMSM19-B REEL
RMSM25-B MAX



RMSM19-B
102-1079



**Fire and Safety
Centre**

Available From:

Fire and Safety Centre
15 Atkinsons Way, Foxhills Industrial Estate
Scunthorpe, North Lincolnshire, DN15 8QJ
Tel: 01724 281044 **Web:** www.fireandsafetycentre.co.uk
Email: sales@fireandsafetycentre.co.uk

FIRECHIEF REELMAX SWINGING MANUAL FIRE HOSE REELS

FIRECHIEF®
making the world a safer place

Features

- Hose reel with powder coated and anti-ultraviolet side discs
- Corrosion resistant full brass waterway
- Leak proof hose fitting used to connect fire hose to water outlet
- High pressure resistance; maximum working pressure, 12 bar
- Robust leak free design providing over 3000 rotations of the hose reel with no leakage
- High pressure spray. The nozzle can be adjusted to jet/spray
- This type of hose reel can be used in a fire hose reel cabinet
- Supplied with LPBC approved EN694 fire hose, ideal for applications where long intervals can occur between use

MODEL:

RMSM19-B REEL
RMSM25-B MAX

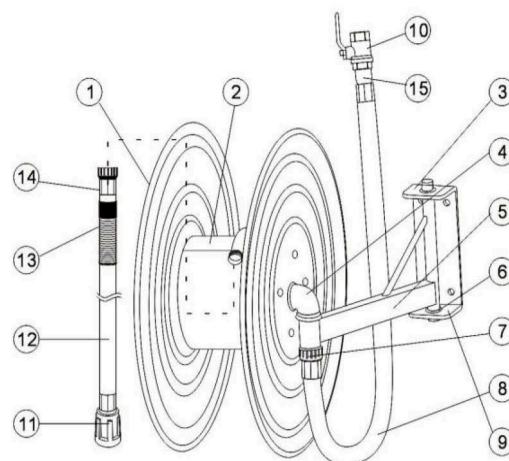

Parts

- | | |
|---------------------|------------------------------|
| 1. Hose Reel Disc | 9. Swinging Arm Pivot |
| 2. Hose Drum | 10. Gate Valve |
| 3. Mounting Bracket | 11. Nozzle |
| 4. Water Inlet | 12. Fire Hose |
| 5. Swinging Arm | 13. Spring Wire Hose Support |
| 6. Locking Screw | 14. Outlet Joint |
| 7. Inlet Joint | 15. Connector |
| 8. Inlet Pipe | |

Usage

1. Open the valve (10), pull towards fire and open nozzle (11) to spray/jet and aim at base of fire.
2. After use, close the valve (10), drain water from the hose, rewind the hose and close nozzle.



| Code | Model | Description | Hose Nominal Bore (mm) | Hose Maximum Length (m) | Nozzle Type | LPBC Ref. No. |
|----------|----------|---|------------------------|-------------------------|---------------------------|---------------|
| 102-1079 | RMSM19-B | Manual, swinging arm, cabinet or wall mounted | 19 | 30 | Rotary operated jet/spray | 1093e/01 |
| 102-1080 | RMSM25-B | Manual, swinging arm, cabinet or wall mounted | 25 | 30 | Rotary operated jet/spray | 1093e/02 |



**Fire and Safety
Centre**

Available From:

Fire and Safety Centre
15 Atkinsons Way, Foxhills Industrial Estate
Scunthorpe, North Lincolnshire, DN15 8QJ
Tel: 01724 281044 **Web:** www.fireandsafetycentre.co.uk
Email: sales@fireandsafetycentre.co.uk